

Wall Mount, Open Stainless Steel Bowl, Hughes Laboratory Eye/Face Wash - L85GS

Product Images

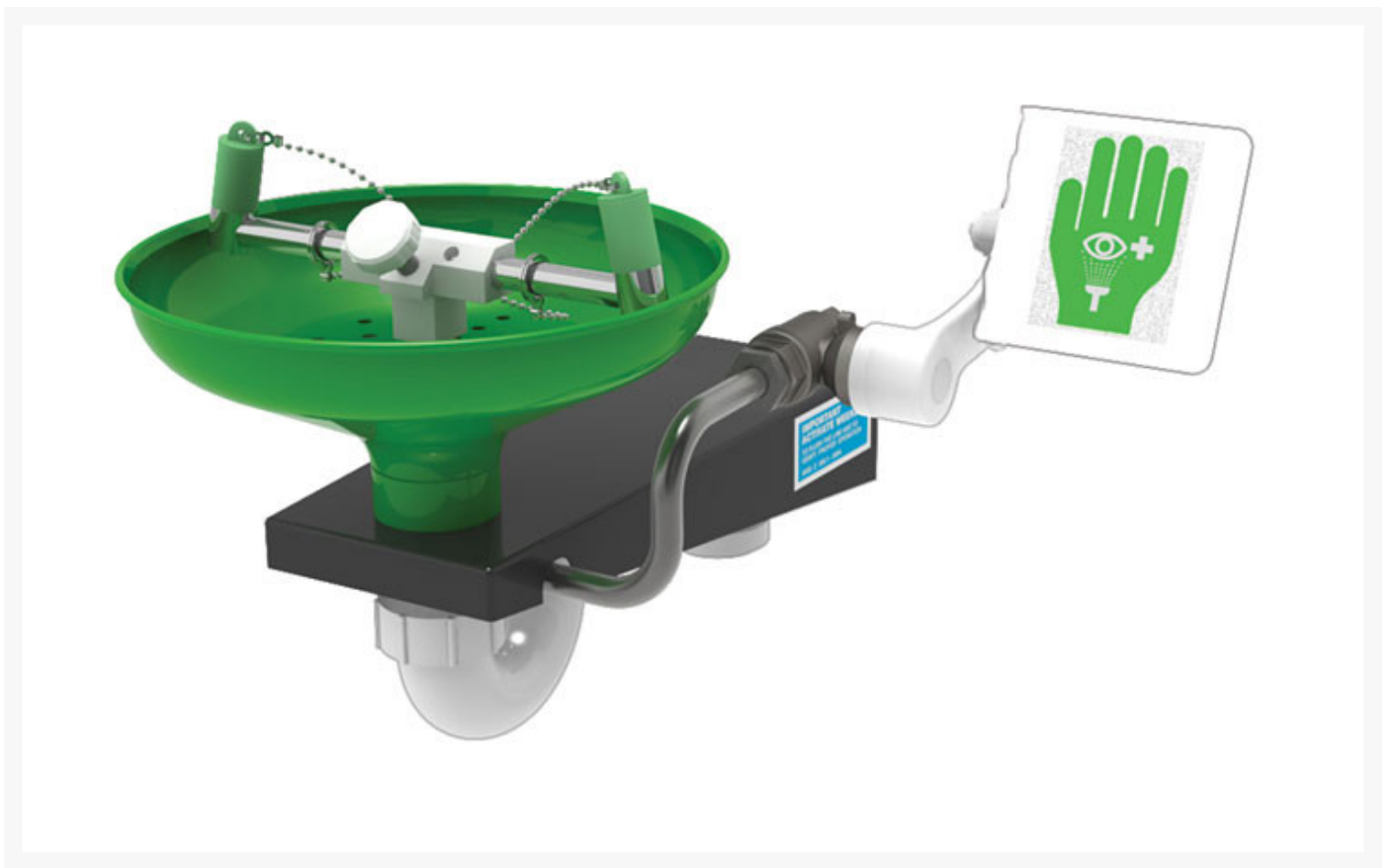

Short Description

HUGHES



Justrite Safety Group

- Easy-to-clean powder coated stainless steel bowl for excellent corrosion resistance
- Pop-off dust covers protect the twin spray nozzles from contaminants
- Fine mesh strainers and an individual flow controller provide a gentle flow of aerated water and prevent further injury to the eyes
- High-performance quarter-turn ball valves made of 316L stainless steel endure the harshest environments and site conditions
- Includes a universal eye wash sign for enhanced visibility

Description

Ideal for laboratories, schools and general light duty indoor use, this wall mounted eye/face wash unit meets ANSI Z358.1 and EN 15154 standards, and supports OSHA requirements. Pop-off dust covers protect the twin spray nozzles from contaminants, and are lifted off by the water jets upon operation via the push plate. Includes an inspection record tag for recording test and service history.

Specifications

Model No	L85GS
Color	Green
UPC	805042000106
Net Weight, lbs	7.7
Net Weight, kg	3.5
Dimensions, Exterior	11.6" H x 16.9" W x 15.7" D
	295mm H x 429mm W x 429mm D
UL Classified to ANSI Z358.1-2014	Yes
Water Inlet Size NPT	1/2 in (F)
Minimum Operating Pressure	2 bar g, 29 PSI
Maximum Operating Pressure	6 bar g, 87 PSI
Water Flow Eye/Face Liters/min	11.4
Water Flow Eye/Face US Gal/min	3
Material Specifications	Eye/facewash diffusers: Chrome plated brass with stainless steel mesh.
Operating Valve Material	316L Stainless
Eye/Face Wash Bowl Material	Green Powder-Coated Stainless Steel
Mounting Type	Wall
Activation Method	Push Plate
Eye/Face Wash Bowl Interior Dimensions	10.25" W x 10.25" D
	260mm W x 260mm D
Minimum Ambient Temperature, °F	41
Minimum Ambient Temperature, °C	5
Maximum Ambient Temperature, °F	95
Maximum Ambient Temperature, °C	35

Prop 65

 **WARNING:** This product can expose you to chemicals including lead, which is known to the State of California to cause cancer and birth defects or other reproductive harm. For more information go to www.P65Warnings.ca.gov.